



ESTABLISHING A B.S. IN GEODESIGN TO FOSTER INTERDISCIPLINARY COLLABORATION

John P. Wilson, Ph.D.

*Professor of Spatial Sciences, Sociology, Architecture,
Civil & Environmental Engineering, and Computer Science*

Founding Director, Spatial Sciences Institute

Visiting Professor, Chinese Academy of Sciences

Geodesign Summit

28 January, 2016

USCDornsife

Dana and David Dornsife
College of Letters, Arts and Sciences

Spatial Sciences Institute



Spatial Sciences Institute

- Established 1st July, 2010
- Rapid growth
- People
 - 15 core faculty
 - 21 faculty affiliates
 - 7 staff
- Facilities
 - Faculty & staff offices
 - Dedicated classrooms & laboratories
 - Large computing infrastructure
- Substantial research enterprise
- Full suite of academic programs





B.S. in Geodesign

USC School
of Architecture

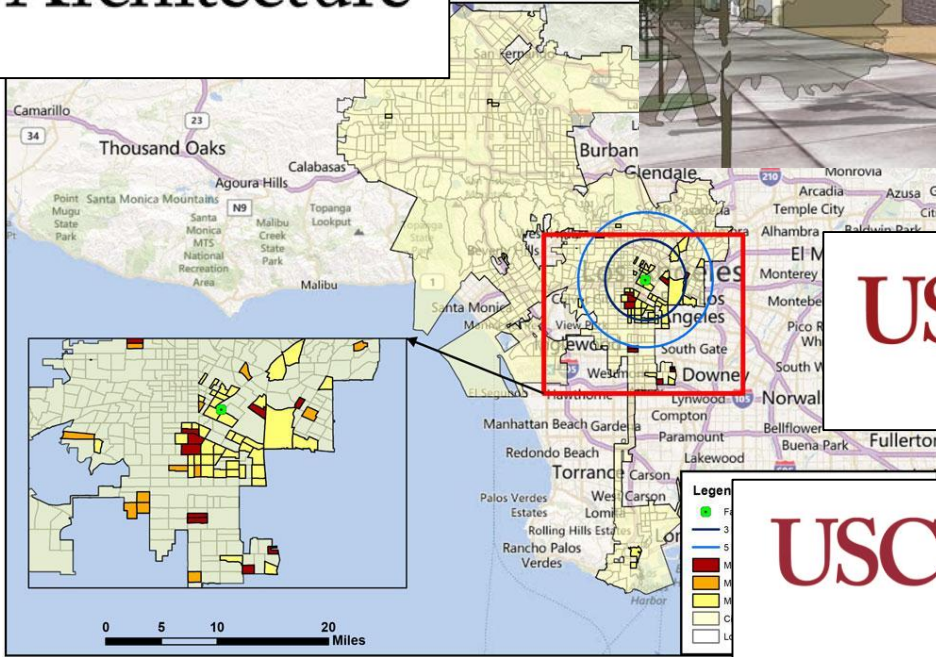

USC Price
Sol Price School of Public Policy

USC Dornsife
Dana and David Dornsife
College of Letters, Arts and Sciences

USC Dornsife

Dana and David Dornsife
College of Letters, Arts and Sciences



Geodesign Curriculum

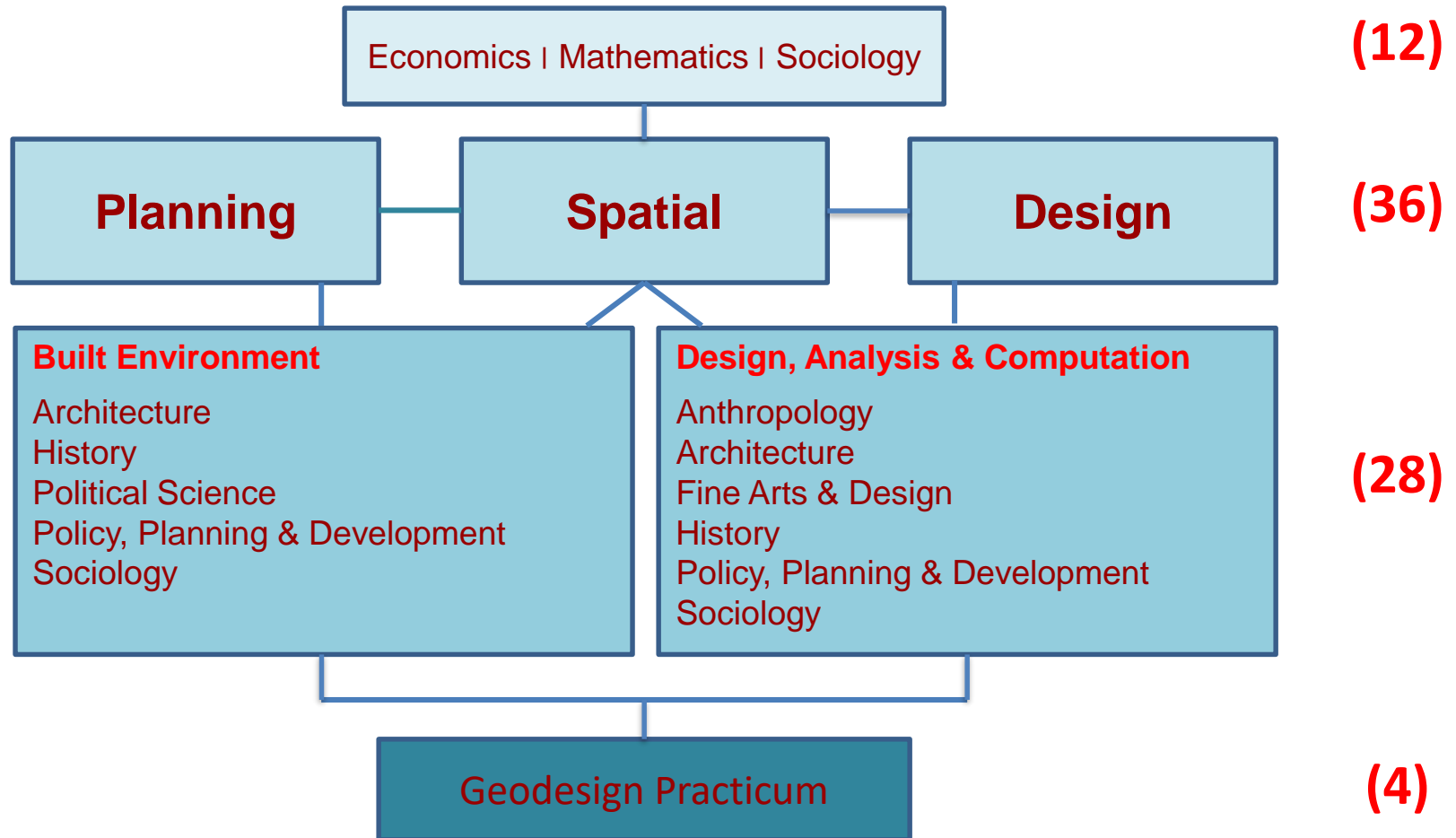



Geodesign Core

Planning

PPD 227 – Urban Planning and Development
PPD 417 – History of Planning and Development
PPD 425 – Designing Livable Communities

Spatial

SSCI 301 – Maps and Spatial Reasoning
SSCI 382 – Principles of Geographic Information Science
SSCI 483 – Spatial Science Practicum

Design

ARCH 203 – Visualizing and Experiencing the Built Environment
ARCH 303 – Principles of Spatial Design I
ARCH 303 – Principles of Spatial Design II

Capstone

ARCH-PPD-SSCI 412 – Geodesign Practicum



SSCI 301: MAPS AND SPATIAL REASONING

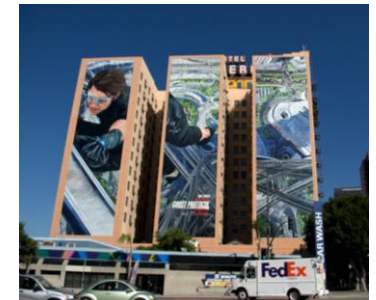
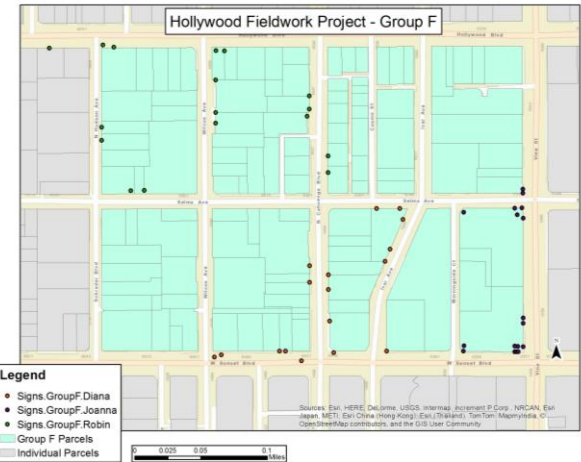
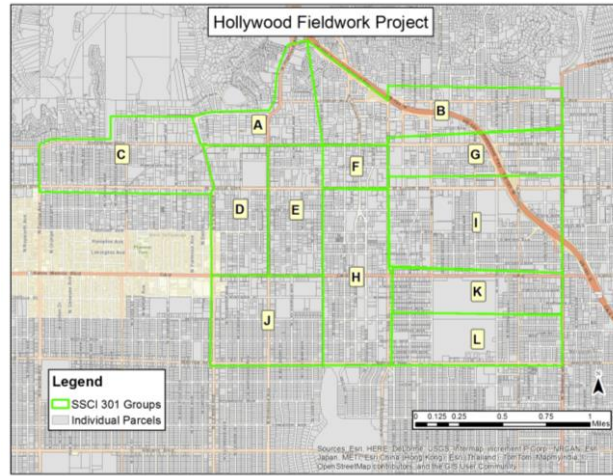

USC Dornsife

Dana and David Dornsife
College of Letters, Arts and Sciences

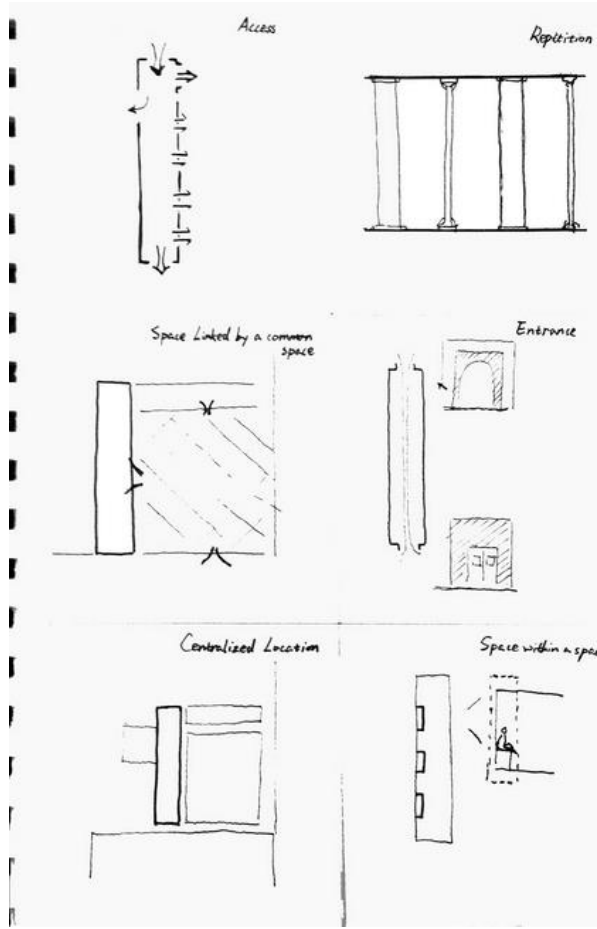
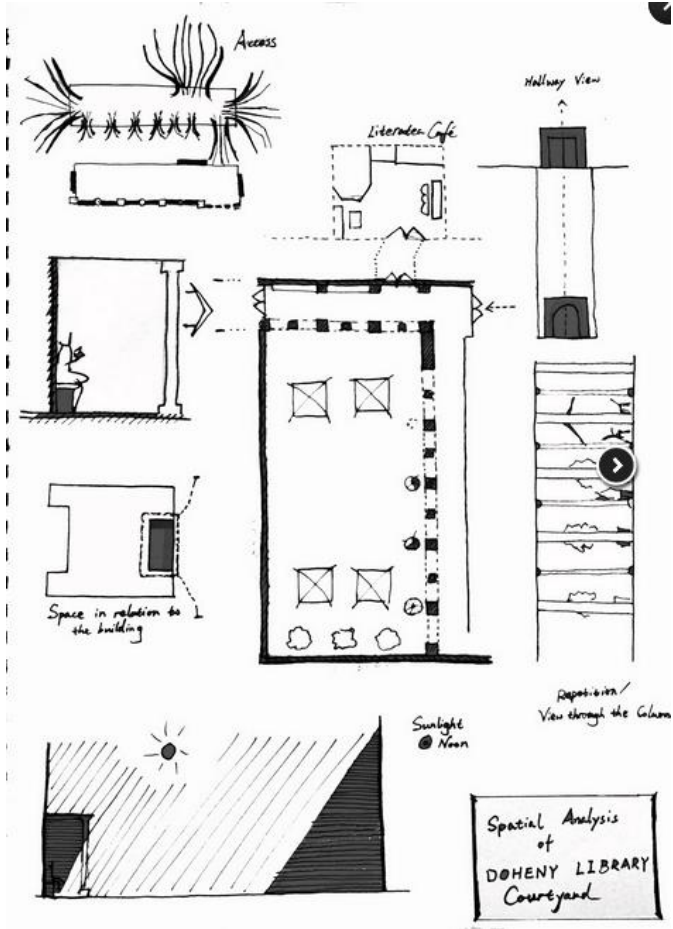

ARCH 303: PRINCIPLES OF SPATIAL DESIGN I



Ziyu Ouyang / Understanding Place through Experience and Analysis / 2015



ARCH 403: PRINCIPLES OF SPATIAL DESIGN II

LEGEND

- R2250 - Medium Density Residential
- SMFU - Commercial/Residential Mixed Use
- IMU - Industrial/Commercial Mixed Use
- C3 - Commercial Service
- SR - Special Recreation
- CC + T - Community Center + Transportation

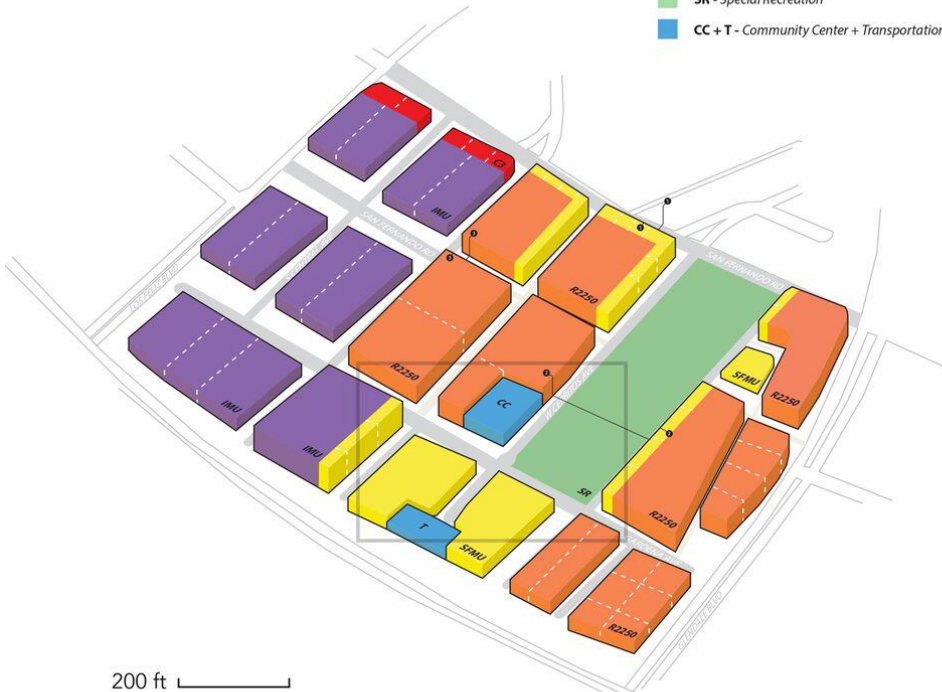

Axonometric Map





SSCI 412: GEODESIGN PRACTICUM



Developing plan and project ideas for recovery of endangered Palos Verdes blue butterfly for an external client, the Disney Conservation Fund





Student Response

SSI Majors and Minors

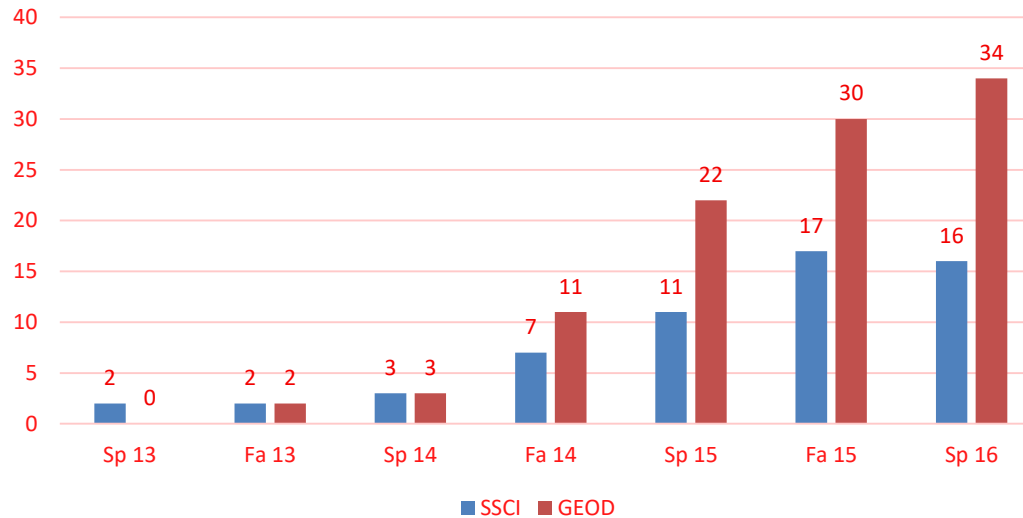

- First major for 9 students
- 25 students changed majors
 - ANTH, ARCH, ASTE, BISC, CHEM, ENGL, ENGR, HBIO, MUSC, PHYS, PLUS, SOCI
- Scholarships & Honors
 - 2 Trustee, 3 Presidential, & 2 Dean's Scholars
 - 14 students made Dean's List in Fall 2015



Enduring Challenges

- Planning and coordination
 - Class scheduling
 - Faculty coordination
 - **Team teaching**
 - Progressive degrees
- Facilities
 - New collaborative classroom
 - Large and diverse computing infrastructure
- Geodesign as a collaborative, socio-political process
 - Teach across several disciplines & spatiotemporal scales
 - Teach & support new workflows
 - Promote community engagement

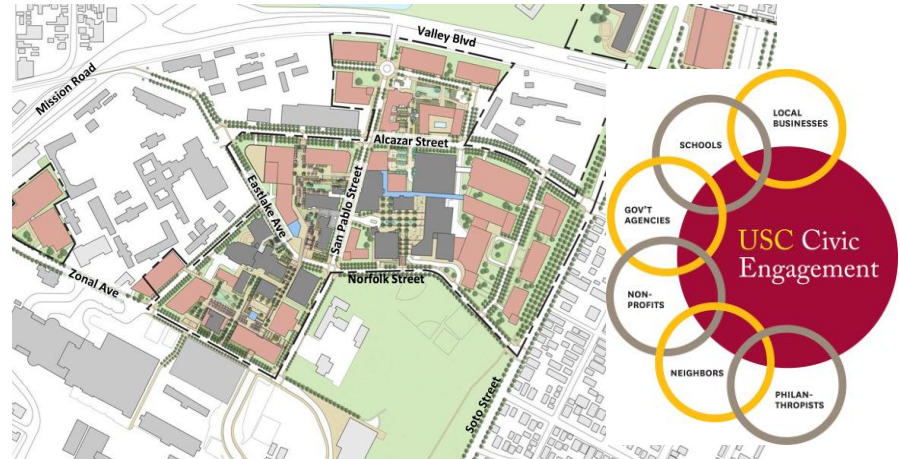



Geodesign ...

- Has the capacity to shift GIS to a whole new approach, one oriented toward collaboration, creation, imagination, experimentation, and with a view towards applying knowledge in a forward looking manner
- The GIS, itself, would then fade into background ...

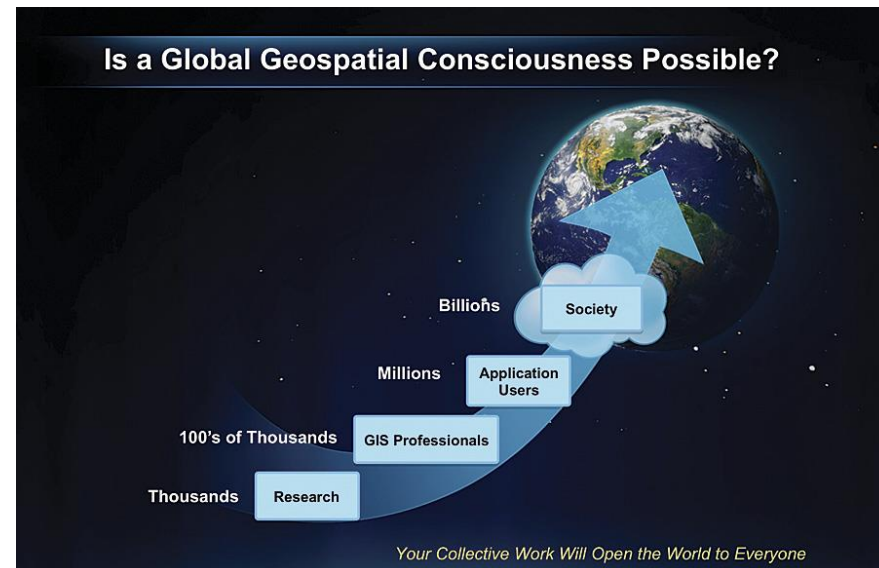



Close || Questions

SSCI 350: International Geodesign



John Wilson

jpwilson@usc.edu

<http://spatial.usc.edu>

USCDornsife

Dana and David Dornsife
College of Letters, Arts and Sciences

CLOSE | 14

Spatial Sciences Institute